

unit 8

CRESCENT COURT BUSINESS CENTRE ■ CANNING TOWN ■ LONDON ■ E16 4TG

CANMOOR

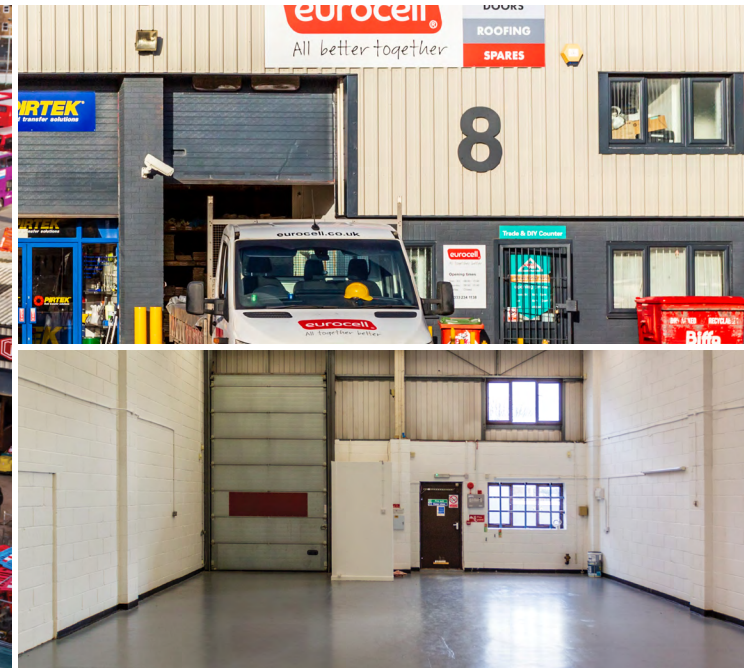

Refurbished Trade Counter/Industrial Unit 1,445 sq ft (134.2 sq m) **TO LET**

- Prominent Location
- Steel portal frame
- Clear height of 7 metres
- Ancillary offices
- 3 Phase electrical supply
- Secure site
- Flexible leases available
- Multiple occupancy solutions
- 2 parking spaces

CANNING TOWN

unit 8

CRESCENT COURT BUSINESS CENTRE ■ CANNING TOWN ■ LONDON ■ E16 4TG

CANMOOR



SAT NAV
E16 4TG

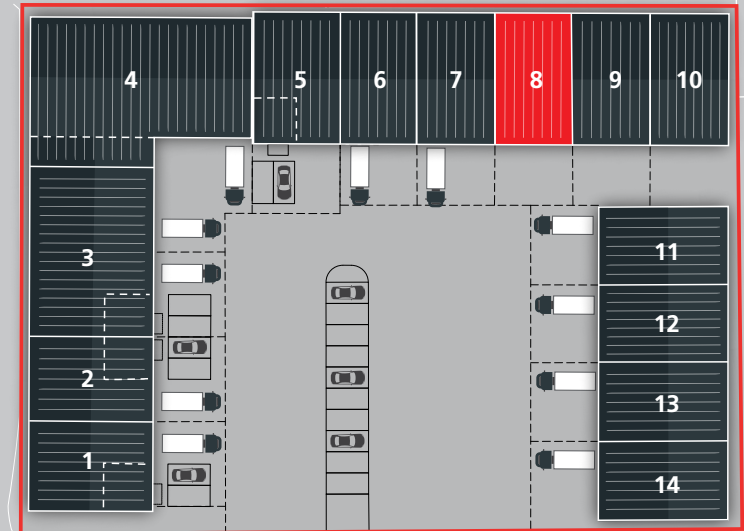

NORTH CRESCENT

Unit 8	sq ft	sq m
Warehouse	1,445	134.2
Total	1,445	134.2

The areas are measured in accordance with the RICS Code of Measuring Practice (6th Edition) on a Gross Internal Basis.

BUSINESS RATES

The unit is listed in the Valuation List 2017 as 'Warehouse and Premises' with a rateable value of £27,000.

TENURE

The property is available by means of a new lease on full repairing and insuring terms for a length to be agreed.

EPC

C, 62

RENT

Rent on application.

FURTHER INFORMATION

For more information and a full proposal, please contact:

**MONTAGU
EVANS**

020 7493 4002

Luca Nardini
07795 501 905
luca.nardini@montagu-evans.co.uk

Will Fennell
07818 538 230
will.fennell@montagu-evans.co.uk

Cameron Aitchison
07721 599 643
cameron.aitchison@montagu-evans.co.uk

GLENNY

020 8591 6671
GLENNY.CO.UK

Peter Higgins
07900 990 805
p.higgins@glenny.co.uk

Ryan Anderson
07468 186 415
r.anderson@glenny.co.uk